

DATA SHEET

Lift and slide door MB-77

U_w-Wert
≥ 1.23



- Flush design
- 174 mm construction depth
- Available with double and triple glazing

Energy saving through new windows

U _w value (old)	3.50 W/(m ² K)
U _w value (new)	1.23 W/(m ² K)
Window area	30 m ²
Annual fuel oil savings	1090 litres
Annual carbon dioxide reduction	2,943 kg

Explanation

Heating degree days	4,050
Conversion factor kilogram into litres of heating oil	1.19
Conversion of calorific value Wh/kg	11,800
Heating efficiency	0.75

PROFILE DESCRIPTION

- Wide heat barriers, polyethylene inserts and uPVC profile
- Weatherproof with continuous mounted pane and compression seals
- Glass strips with closed shape for increased break-in protection
- Triple glazing up to U_g-value 0.6 W/m²K
- Siegenia-Aubi HS-PORTAL 300KF*
- Installation with corner coupling possible**
- High level of basic security with two locking bolts as standard
- Thermal, safety and sound insulation glazing possible
- Smooth operation even with heavy sash weights
- Concealed locking technology with swivel hook gear
- High resistant to wind and driving rain
- Increased light exposure with a large glass surface

* If the sash weight exceeds 300 kg, we use fittings from a manufacturer of the same or higher quality.

**For special constructions with corner coupling, please contact our customer service department.

COLOURS

- White RAL 9016,
Anthracite grey RAL 7016,
White aluminium RAL 9006
Grey aluminium RAL 9007
- All alu special colours listed in the shop

GLASS THICKNESS

14 mm to 58 mm

SEALS

- Black

OPTIONAL

- Additional break-in protection with security fitting up to RC2 N
- Integrated door gear, lockable from inside and outside
- Lock monitoring according to VDI

SYSTEM VALUES

- Air permeability: Class 4 (according to EN 12207)
- Driving rain-proof: Class 9A (according to EN 12208)
- Water tightness against driving rain:
up to class C4 (according to EN 12210)

Please note:

The classes given here are minimum classes. For higher requirements please consult us.

THERMAL INSULATION

- Reference size 3500 x 2180 mm
- Minimum requirements according to GEG 2020:

$$U_w = 1.3 \text{ W/(m}^2\text{K)}$$

U_w window (W/m²K)

U_g Glass according to EN 673	Frame U_f value	Insulating glass spacer alu	Insulating glass spacer KSD	Insulating glass spacer Swis- spacer Ultimate
1.1	2.3	1.7 (1.68)	-	1.6 (1.61)
1.0	2.3	1.6 (1.61)	-	1.5 (1.54)
0.7	2.3	1.4 (1.38)	-	1.3 (1.31)
0.6	2.3	1.3 (1.34)	-	1.2 (1.23)

U_w values < 1.0 W/(m²K) are shown with two decimal places in accordance with EN ISO 10077

U_w values > 1.0 W/(m²K) are shown with one decimal place according to EN ISO 10077, here with two decimal places for information purposes

TECHNICAL DATA

Technical Data	MB-77
Frame depth	174 mm (Profile with two running tracks)
Sash depth	77 mm
Glazing	13.5 mm – 58.5 mm
Visible profile width	
Frame min.	48 mm
Sash min.	94.5 mm – 105.5 mm

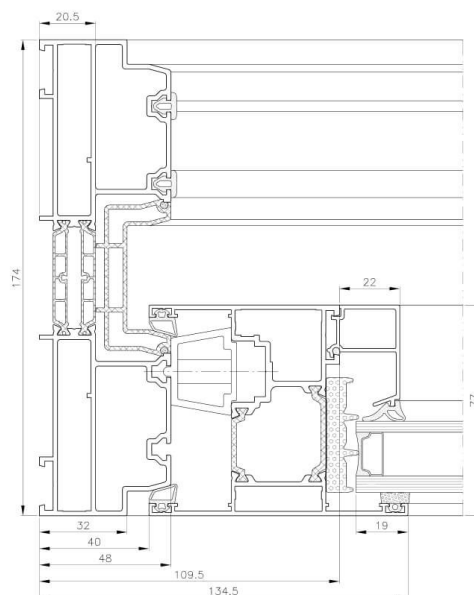

LIFT AND SLIDE DOOR MB-77:
FIXED SASH OUTSIDE LEFT

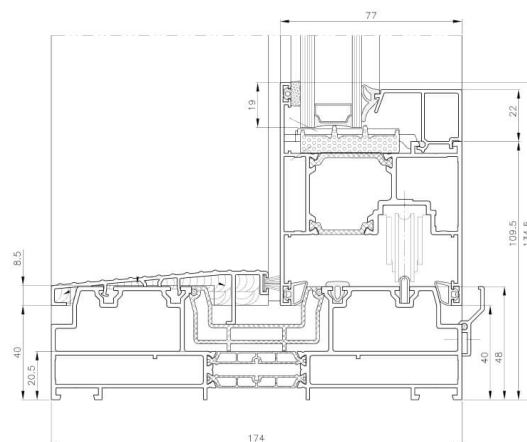

LIFT AND SLIDE DOOR MB-77:
THRESHOLD AT THE BOTTOM INSIDE
WITH SLIDING SASH

POSSIBLE SCHEMA:

SCHEMA A

